

DR

Phonetic Calculator

There are many mathematical tools and techniques intended to generate a numerical answer. The only intended to improve the accuracy of the answer.

There are many factors that will impact the actual performance of a mathematical tool. Manufacturing variations in the components of the tool can impact the accuracy of the answer.

When a tool is selected, the knowledgeability of the user is a factor. The user must be able to use the tool correctly. The accuracy of the answer will increase when the user is knowledgeable.

That the accuracy of the answer increases when the user is knowledgeable.

NB: Reflections have been made. The accuracy of the answer will increase when the user is knowledgeable.

PZ21-12000028

10/20/2021

OSQ Series

Product Description

Performance Summary

Utilizes Cree TrueWhite® Technology on 5000K Luminaires

NanoOptic® Precision Delivery Grid™ optic

Assembled in the U.S.A. of U.S. and imported parts

Initial Delivered Lumens: 4,000 - 30,000

Efficacy: Up to 173 LPW

CRI: Minimum 70 CRI (3000K, 4000K & 5700K); 90 CRI (5000K)

CCT: 3000K, 4000K, 5000K, 5700K

Limited Warranty†: 10 years on luminaire; 10 years on Colorfast DeltaGuard® finish; up to 5 years for Synapse® accessories; 1 year on luminaire accessories

Ordering Information

Fully assembled luminaire is composed of two components that must be ordered separately:

Example: **Mount:** OSQ-ML-B-AA-BK + **Luminaire:** OSQM-B-4L-30K7-2M-UL-NM-BK

Technical drawing of the OSQM-ML-B-DA and UC Mounts. The drawing includes a perspective view of the luminaire and two detailed views of the mounting bracket.

Dimensions:

- OSQM: 25.0" (635mm)
- OSQL: 27.2" (691mm)
- Mounting Bracket Width: 19.0" (482mm)
- Mounting Bracket Height: 3.5" (89mm)
- Mounting Bracket Width (Side View): 8.1" (205mm)
- Mounting Bracket Height (Side View): 3.1" (79mm)
- Mounting Bracket Length (Side View): 4.0" (102mm)
- Mounting Bracket Length (Side View): 4.9" (124mm)

Labels:

- NEMA® 7-Pin Photocell Receptacle location (ordered as an option)

Luminaire	Weight
OSQM	28.9 lbs. [13.1kg]
OSQL	32.4 lbs. [14.7kg]

Note: Refer to page 11 for fixture mounting drill pattern. For additional mounts, refer to drawings beginning on page 19

Luminaire (Mount must be ordered separately)									
OSD	B		Lumen Package	CCT/CR	Optic	Voltage	Mount	Color Options	
Family	Size	Series							Options
OSD	M Medium L Large	B	Medium 4,000 Lumens	30K7 3000K, 70 CRI	Asymmetric 2M	UL Universal 120-277V	NM No Mount	BK Black	PM1. Programmable Multi-Level, up to 40° Mounting Height - Refer to PML_spec_sheet for details - Intended for downlight applications at 0° tilt PM2. Programmable Multi-Level, 10-30° Mounting Height - Refer to PML_spec_sheet for details - Intended for downlight applications at 0° tilt 09/08/07/04/05/04/03/02/01 Field Adjustable Output - Must select 09, 08, 07, 04, 05, 04, 03, 02, or 01 - Offers full range adjustability - Refer to pages 12-18 for power and lumen values - Not available with PM1 or PM2.1 options X8/X7/X6/X5/X4/X3/X2/X1 Locked Lumen Output - Must select add X8, X7, X6, X5, X4, X3, X2, or X1 - Not available with 72L or 30L lumen packages - Not available with PM1, or PM2.1 options - Lumen output is permanently locked to the setting selected - Refer to pages 12-18 for power and lumen values
			4L 4000K, 70 CRI	3M+ Type II Medium	UH Universal 347-480V	MM Must specify mount from table above	BZ Bronze		
			4L 4000 Lumens	4M+ Type III Medium	UL Universal 347-480V	MS Mount ships separately	SV Silver		
			9L 5000K, 90 CRI	5M Type IV Medium	- Not available with 4L or 4L lumen packages	WH White			
			9L 5000 Lumens	Symmetric SM	45° Utility Arm w/B* 1/4" AWG Cord				
			11L 57K 90 CRI	5N Type V Medium	Side Exit				
			11L 57K 90 Lumens	5N Type V Medium	- Includes N option				
			14L 16,000 Lumens	50 Type V Square	45° Utility Arm w/B* 1/4" AWG Cord				
			14L 16,000 Lumens	50 Type V Square	End Exit				
			14L 16,000 Lumens	50 Type V Square	- Includes N option				
OSD	M Medium L Large	B	Large 22L 22,000 Lumens	N3 Narrow Flood	3NEMA 3x3	Direct Arm Mount			F Fuse Compatible with 120V, 277V or 347V (phase to neutral) - Consult factory if fusing is required for 208V, 240V or 480V (phase to phase) - Refer to PML_spec_sheet for availability with PM1 options When code dictates fusing, use time delay fuse N Utility Label and NEMA® 7-Pin Photocell Receptacle - Includes with UA, UB, UC and UD mounts - External wattage label per ANSI C136.15 - 7-pin receptacle per ANSI C136.41 - Intended for downlight applications with maximum 55° tilt Factory connected 0-10V dim leads - 7-conductor (NM mount), 3-conductor (UA/UB mounts), or 5-conductor (UC/UD mounts) cord exits luminaire - Requires photocell or shorting cap by others R NEMA® 7-Pin Photocell Receptacle - 7-pin receptacle per ANSI C136.41 - Intended for downlight applications with maximum 55° tilt Factory connected 0-10V dim leads - 18" (457mm) seven conductor cord exits luminaire - Requires photocell or shorting cap by others RL Rotate Left - LED and optic are rotated to the left - Refer to R/R/LR configuration diagram on page 19 for optic directionality Not for use with symmetric optics RR Rotate Right - LED and optic are rotated to the right - Refer to R/R/RL configuration diagram on page 19 for optic directionality Not for use with symmetric optics
			30L 30,000 Lumens	55 NEMA 4x4	Standard 2" (51mm) bolt spacing				
			30L 30,000 Lumens	55 NEMA 4x4	Shipped separately				
			30L 30,000 Lumens	55 NEMA 5x5	Field installed				
			30L 30,000 Lumens	66 NEMA 6x6	- Includes N option				
			30L 30,000 Lumens	75 NEMA 7x5	Transunion Mount				
			30L 30,000 Lumens	75 NEMA 7x5	Adjustable from 0-45° in 15° increments				
			30L 30,000 Lumens	75 NEMA 7x5	- Includes N option				
			30L 30,000 Lumens	75 NEMA 7x5					
			30L 30,000 Lumens	75 NEMA 7x5					

** Luminaire comes standard with 0-10V dimming



CREE  **LIGHTING**

#	Date	Comments

Drawn By: JS
Checked By:
Date: 7/5/2021

Scale: N.T.S.

Drawn By: JS
Checked By:

Checked By: _____
Date: 7/5/2021

Date: 7/5/2021

Scale: N.T.S.

St. Phillip Church

Parking Lot

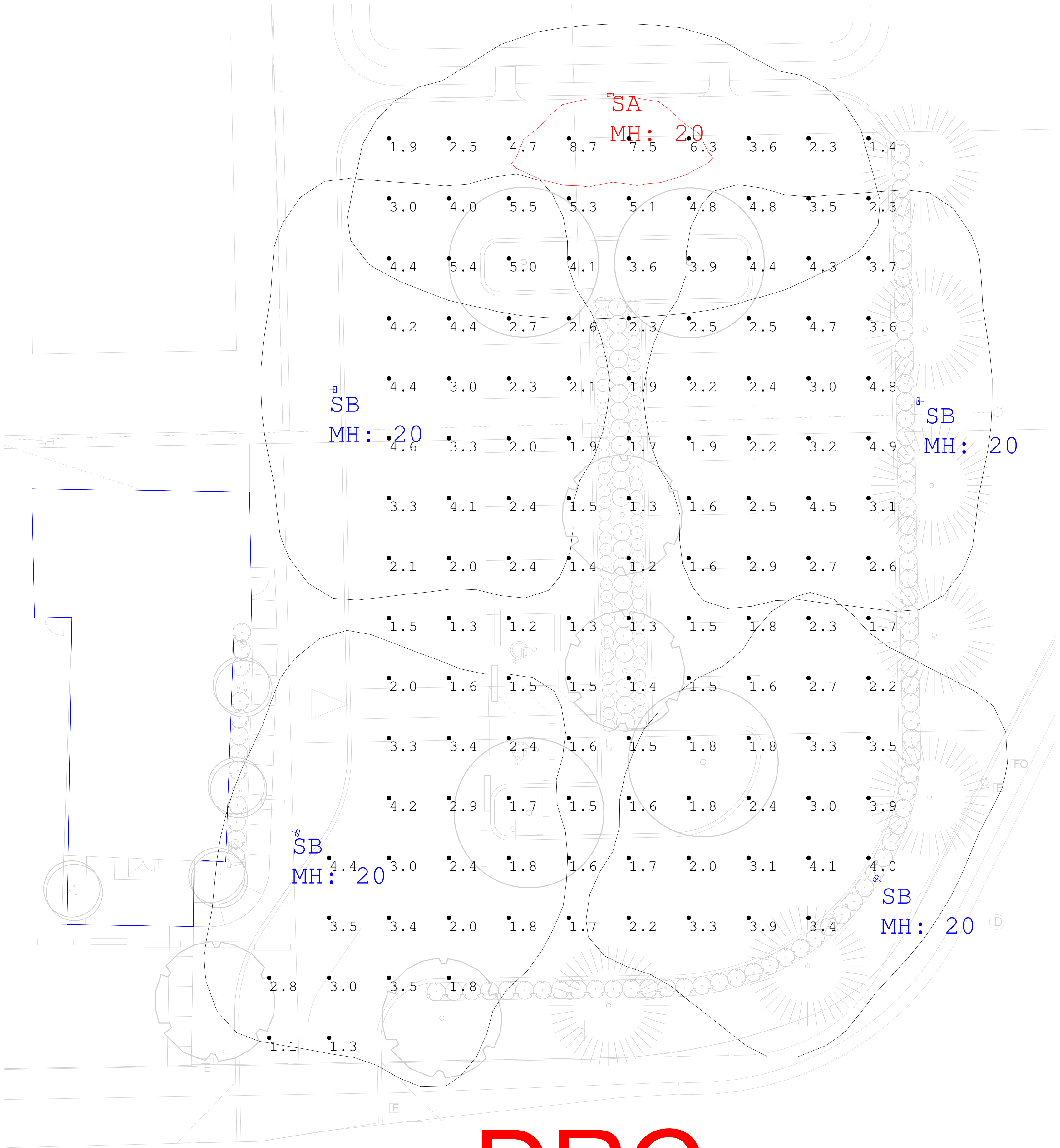

Scale: 1 inch= 10 Ft.

DRC

PZ21-12000028
10/20/2021

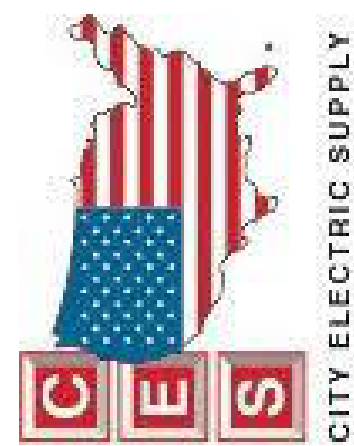

Revisions				
#	Date	Comments		

Drawn By: JS	Checked By:	Date: 7/5/2021	Scale: 1" = 10'

St. Phillip Church	Parking Lot